



ABSOLUTE
QUALITY
MADE IN
FINLAND



P32CS SCC

CS-models have been designed for service van use. CS machines are battery powered with 12V or 24V, crimping head on left as standard.

New Smart Crimping Control (SCC) brings smartness and connectivity for service and workshop machines. It is easy to use with features such as diameter crimping, recipes and data recording. A magnetic attachment makes it easy to change the place of control.

TECHNICAL DATA

Max crimping dia (mm/inch) ¹⁾	87/3.42
Max crimping dia with master dies (mm/inch)	109/4.3
Max. crimping force (kN)	2000
Max. crimping force (tonnage)	200
Cycle time 10 mm ²⁾	21.1
Hydraulic hose size (inch)	2 *
Industrial hose size (inch)	3.42 *
Die set series	32
Max. opening (mm)	+33
Max. opening without dies (mm)	132
Master die D/L (mm)	99/80
Master die D/L (inch)	3.90/3.15
Motor Power (kW) ³⁾	1.6/2.2
Motor Power (HP) ³⁾	2.1/3.0
Oil tank volume	5 l

DIMENSIONS (LxWxH)

(mm)	601x457x558
(inch)	23.7x18.0x22.0

WEIGHT (KG/LBS)

130/287

* ACCORDING TO THE FITTING.

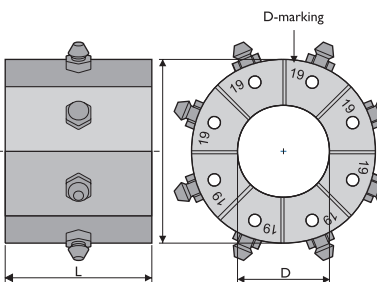

1) With standard dies. Crimping range can be increased with special dies.
2) Theoretical with 10 mm cycle.
3) 12V / 24V. Overload controlled

CONTROL

SCC (5" touchscreen)

MODELS

CS SCC left (12V or 24V)

OPTIONS

- Mechanical back stop device (part no 705510)
- Electrical back stop device (part no 720196)
- Tool rack with QuickChange-tool (part no 692740)
- Foot pedal (part no 691563)
- QuickChange-tool (part no 701049)

DIE SET 32-SERIES

DieSetNo	D (mm)	L (mm)	Crimp. range (mm)
18506/10	10	55	10.0-12.0
18506/12	12	55	12.0-14.0
18506/14	14	55	14.0-16.0
18506/16	16	55	16.0-19.0
18506/19	19	55	19.0-22.0
18506/22	22	70	22.0-26.0
18506/26	26	70	26.0-30.0
18506/30	30	70	30.0-34.0
18506/34	34	75	34.0-39.0
18506/39	39	75	39.0-45.0
18506/45	45	90	45.0-51.0
18506/51	51	90	51.0-57.0
18506/57	57	100	57.0-63.0
18506/63	63	110	63.0-69.0
18506/69	69	110	69.0-75.0
18506/74	74	110	74.0-80.0
18506/78	78	110	78.0-87.0

In addition to the standard die sets, a wide range of special die sets is available on request.